

# PS15k2 C-SJ42-6

## Solar Submersible Pump System for 6" wells

### System Overview

|           |              |
|-----------|--------------|
| Head      | max. 50 m    |
| Flow rate | max. 65 m³/h |

### Technical Data

#### Controller PS15k2

- Control inputs for dry running protection, remote control etc.
- Protected against reverse polarity, overload and overtemperature
- Integrated MPPT (Maximum Power Point Tracking)

|                 |             |
|-----------------|-------------|
| Power           | max. 15 kW  |
| Input voltage   | max. 850 V  |
| Optimum Vmp*    | > 575 V     |
| Motor current   | max. 24 A   |
| Efficiency      | max. 98 %   |
| Ambient temp.   | -30...50 °C |
| Enclosure class | IP54        |

#### Motor AC DRIVE SUB 6" 11kW

- Highly efficient 3-phase AC motor
- Frequency: 25...50 Hz
- Premium materials, stainless steel: AISI 304
- No electronics in the motor

|                  |                   |
|------------------|-------------------|
| Motor speed      | 1,400...2,850 rpm |
| Power factor     | 0.87              |
| Insulation class | F                 |
| Enclosure class  | IP68              |
| Submersion       | max. 300 m        |

#### Pump End PE C-SJ42-6

- Non-return valve
- Premium materials, stainless steel: AISI 304
- Optional: dry running protection
- Centrifugal pump

#### Pump Unit PU C-SJ42-6 (Motor, Pump End)

|                   |             |
|-------------------|-------------|
| Borehole diameter | min. 6,0 in |
| Water temperature | max. 30 °C  |

### Standards

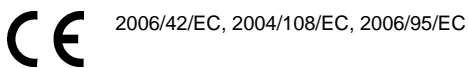

2006/42/EC, 2004/108/EC, 2006/95/EC

Meets the requirements of:  
IEC/EN 61702:1995,  
IEC/EN 62253 Ed.1

The logos shown reflect the approvals that have been granted for this product family. Products are ordered and supplied with the approvals specific to the market requirements.

\*Vmp: MPP-voltage under Standard Test Conditions (STC): 1000 W/m² solar irradiance, 25 °C cell temperature



## PS15k2 C-SJ42-6

### Solar Submersible Pump System for 6" wells

#### Pump Chart

V<sub>mp</sub>\* > 575 V

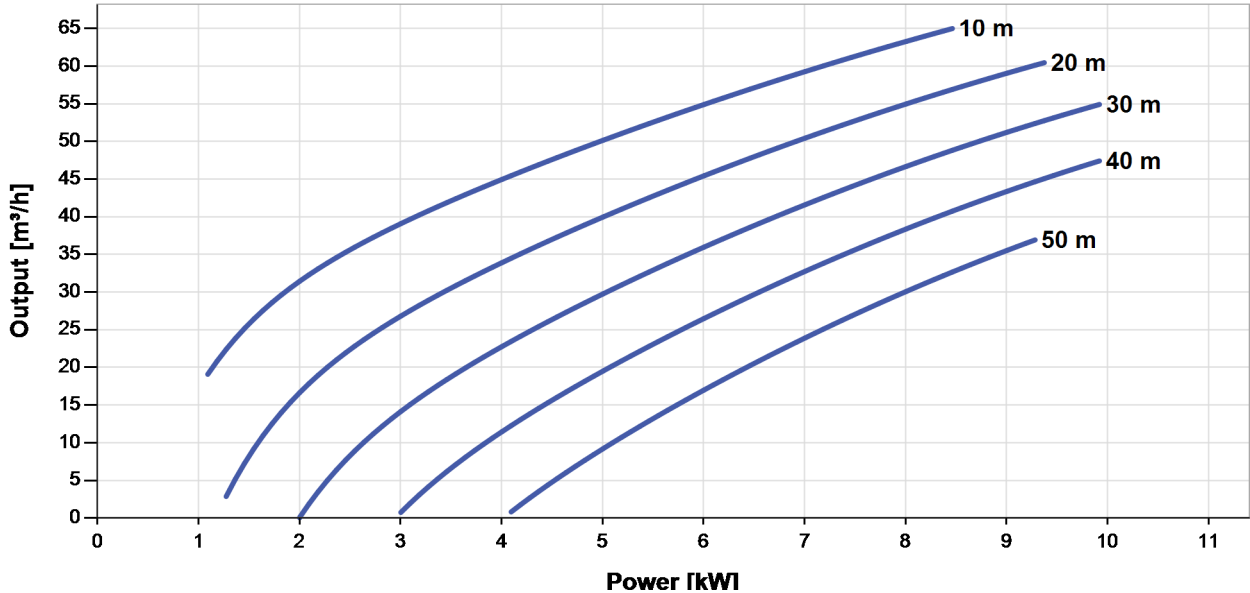

#### Dimensions and Weights

##### Controller

H = 500 mm  
 H1 = 450 mm  
 H2 = 425 mm  
 W1 = 320 mm  
 W2 = 290 mm  
 D = 9.0 mm  
 D1 = 220 mm  
 D2 = 250 mm

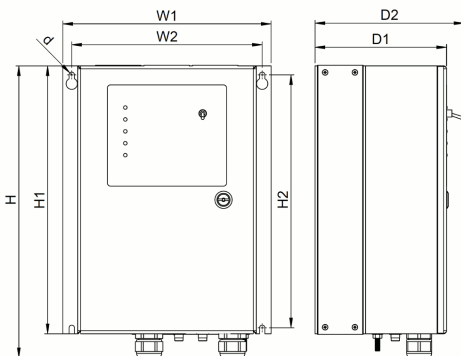

##### Pump Unit

A = 1,670 mm  
 B = 711 mm  
 C = 959 mm  
 D = 144 mm  
 E = 147 mm  
 S = 3 in

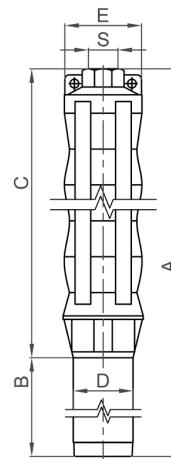

|            | Net weight |
|------------|------------|
| Controller | 17 kg      |
| Pump Unit  | 80 kg      |
| Motor      | 58 kg      |
| Pump End   | 22 kg      |

\*V<sub>mp</sub>: MPP-voltage under Standard Test Conditions (STC): 1000 W/m<sup>2</sup> solar irradiance, 25 °C cell temperature

