



Steca Xtender XTH

3000-12, 5000-24, 6000-48, 8000-48

The basic functions of the combined inverter of the Steca Xtender series are the inverter, the battery charger, the switching function and the support of external sources of alternating current. These functions can be combined and controlled fully automatically, the range offers outstanding user-friendliness and very good exploitation of the energy available.

All the settings of the Steca Xtender XTH can be remote controlled. When a software with new functions is available, it can be loaded into the system, so the Steca Xtender XTH always stays up to date. Several Steca Xtender XTH can be connected in parallel or to form a three-phase system. That means that up to nine Steca Xtender XTH can work together.

Multifunction contacts

These potential-free contacts can be programmed for many different applications. They can react to any event outside or inside of the inverter (grid availability, battery voltage, fault message ...) They can also be programmed on a timer or can be switched on during particular times (at night, at the weekend ...). In this way, they can serve to start up a generator, to switch off less important loads, to signal a fault, to charge batteries depending on the situation, etc.

Smart-boost function

With the smart-boost function, the output of another source of alternating current, such as a power generator or a land connection, can be increased; even when special loads are being used (inductive, asymmetric, with high switch-on current). It is also possible to combine the Steca Xtender XTH with almost all inverters which are already present in order to increase the available output.

Product features

- True sine wave voltage
- Excellent overload capabilities
- Optimal battery protection
- Adjustable integrated battery charger
- Multistage programmable battery charger with PFC
- Automatic load detection
- Standby load detection adjustable over a wide range, starting from a low value
- Parallel connectable
- Best reliability
- Can be used as a back-up system or uninterruptible power supply (UPS)
- Multifunction contact
- Adjustable power sharing
- Reliable and noiseless with any kind of load
- Support of sources of alternating current (Smart Boost)
- Automatic support for peak loads (Power Shaving)
- Ultra-fast transfer relay
- High efficiency
- Control by digital signal processor (DSP)

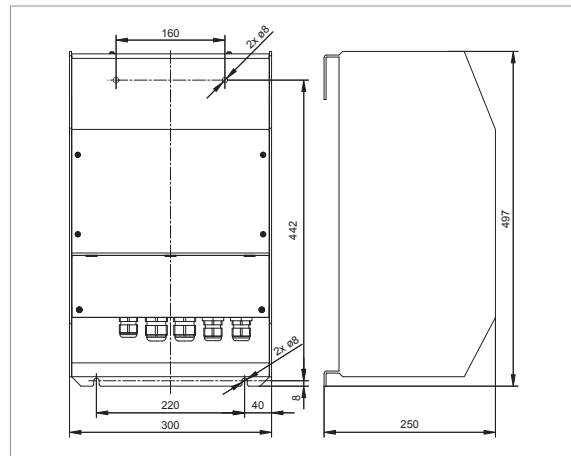

Electronic protection functions

- Deep discharge protection
- Battery overvoltage shutdown
- Overtemperature and overload protection
- Short circuit protection
- Reverse polarity protection by internal fuse (except Steca Xtender XTH 3000)
- Acoustic alarm at deep discharge or overheating

Displays

- 5 LEDs show operating states
- for operation, fault messages

Operation

- Main switch
- Adjustable load detection

Options

- Type with 115 V / 60 Hz (except Steca Xtender XTH 8000-48)
- Model with protective lacquered mainboard
- Temperature sensor BTS-01 to correct the voltage thresholds according to the current battery temperature

Certificates

- Compliant with European Standards (CE)
- RoHS compliant

[areas of application]





	XTH 3000-12	XTH 5000-24	XTH 6000-48	XTH 8000-48
Characterisation of the operating performance				
System voltage	12 V	24 V	48 V	48 V
Continuous power	2,500 VA	4,500 VA	5,000 VA	7,000 VA
Power 30 min.	3,000 VA	5,000 VA	6,000 VA	8,000 VA
Power 5 sec.	7.5 kVA	12 kVA	15 kVA	21 kVA
Max. efficiency	93 %	94 %	96 %	96 %
Own consumption standby / ON	1.4 W / 14 W	1.8 W / 18 W	2.2 W / 22 W	2.4 W / 30 W
Power Factor Correction (PFC)	according EN 61000-3-2			
Acoustic level	< 40 dB / < 45 dB (without / with ventilation)			
Input side				
Input voltage	< 265 V AC (adjustable: 150 V AC ... 265 V AC)			
Charging current adjustable	0 A ... 160 A	0 A ... 140 A	0 A ... 100 A	0 A ... 120 A
Max. current on transfer system	50 A			
Input frequency	45 Hz ... 65 Hz			
Battery side				
Battery voltage	9.5 V ... 17 V	19 V ... 34 V	38 V ... 68 V	38 V ... 68 V
AC output side				
Output voltage	230 V AC +/- 2 % / 190 V AC ... 245 V AC (true sine wave)			
Output frequency	50 Hz, adjustable: 45 Hz ... 65 Hz +/- 0.05 % (crystal controlled)			
Total harmonic distortion	< 2 %			
Load detection (standby)	2 W ... 25 W			
Operating conditions				
Ambient temperature	-20 °C ... +55 °C			
Fitting and construction				
Power Smart-Boost 30 min.	3,000 VA	5,000 VA	6,000 VA	8,000 VA
Input current balance adjustment	1 A ... 50 A			
Multifunction contact adjustable	2 independent contacts 16 A / 250 V AC (potential free change-over contacts)			
Degree of protection	IP 20			
Dimensions (X x Y x Z)	300 x 497 x 250 mm			
Weight	34 kg	40 kg	42 kg	46 kg
Cooling principle	fan from 55 °C			
Parallel connection possible	3 x 1 phase and three-phase			

Technical data at 25 °C / 77 °F



Steca RCC-02

Remote control and display
(incl. 2 m cable)

Suitable for wall-mounting.

Not illustrated:

Steca RCC-03

Remote control and display
(incl. 2 m cable)

Suitable for rack installation.

Steca BTS-01

Battery temperature sensor
(incl. 5 m cable)

This sensor allows the battery voltages to be adjusted to the battery temperature..

Communications cable

Connection to the three-phase system or to the parallel connection CAB-RJ45-2 (2 m)

This is used to connect several inverters together to a three-phase system or a system connected in parallel.



Steca X-Connect system

Prewired mounting structure for devices from the Steca Xtender XTH series